



## Technical specifications



**Contents**

Technical data .....	2
Construction.....	3
Sails and rigging.....	3
Hardware.....	3
Mooring and anchoring .....	3
Engine.....	4
Plumbing.....	4
Electrical .....	4
Deck layout.....	5
Windows, openings and ventilation .....	6
Interior layouts .....	6
3 cabin 3 bathroom version.....	8
4 cabin 4 bathroom version .....	12

## Technical data

Length overall	12.80 m / 42'
Length	12.50 m / 41'
Maximum beam	7.70 m / 25'3"
Air draft	20.65 m / 67'9"
Draft	1.25 m / 4'1"
Displacement (CE)	12.1 t / 26,681 Lbs
Upwind sail area (std mainsail)	90 m <sup>2</sup> / 968 sq.ft.
Upwind sail area (square top mainsail)	94 m <sup>2</sup> / 1011 sq.ft.
Fully battened mainsail	55 m <sup>2</sup> / 592 sq.ft.
Square top mainsail (option)	59 m <sup>2</sup> / 635 sq.ft.
Self-tacking jib	35 m <sup>2</sup> / 377 sq.ft.
Code 0 (option)	68 m <sup>2</sup> / 732 sq.ft.
Fresh water capacity	300 L / 79 Us Gal
Fuel capacity	300 L / 79 Us Gal
Engines	2 x 45 hp CR to 2 x 57 hp CR
Architects	VPLP Design
Exterior design	Patrick le Quément
Interior design	Nauta Design
Number of berths	6 to 12
CE Certification	A : 12 – B : 14 – C : 20 – D : 30

## NORTH AMERICAN SPECIFICATIONS

*Only for boats sold in US*

- 120V Electric panel and electric equipment
- US 120V outlets
- Gas propane circuit with solenoid valve

## Construction

- Polyester and high quality anti-osmotic resin
- Hull and deck and coachroof laminated by infusion
- Balsa core hull, solid laminate under waterline, white gel coat
- Balsa core bridge deck and deck
- Laminated or glued marine plywood bulkheads

## Sails and rigging

### SAILS

- 1 high roach mainsail in Dacron with battens
- 1 self-tacking jib in Dacron with UV protective band on furler,

### STANDING RIGGING

- Anodized aluminum mast with mainsail ball bearing track system
- 1 level of spreaders
- Anodized aluminum boom
- 2 encased shrouds
- 2 shroud chainplates
- 2 forestay chainplates
- 1 self-tacking jib forestay with furler
- Lazy-jack adjustable on cleat at the foot of the mast
- Deck light on the mast

### RUNNING RIGGING

- 1 double purchase Spectra mainsail halyard
- 1 Spectra self-tacking jib halyard
- 1 pre-stretched mainsail sheet
- 1 pre-stretched self-tacking jib sheet
- 3 reefing lines (1<sup>st</sup> Dyneema)
- 1 pre-stretched self-tacking jib furling line
- 2 pre-stretched mainsail traveler car control lines

## Hardware

- 2 manual winches 46.2 STA
- 1 mainsail track with ball-bearing car
- 1 self-tacking jib track
- Anodized aluminum crossbeam with fixing point for the self-tacking jib furler, anchor roller
- Navigation lights on the forward decks and at the back of the coachroof

## Mooring and anchoring

- Composite longitudinal crossbeam with integrated chain run and mooring cleat
- 8 mooring cleats
- 1000W / 12V electrical windlass with vertical axis, gypsy (chain 10mm)
- Access to windlass and to anchor locker

## Engines

- 2 diesel engines YANMAR 4JH45 45hp common rail saildrive
- Fixed two blade propeller
- Raw water filter
- Mechanical engine throttles at the helm station
- Engine compartment ventilation : electrical extraction in the aft transom
- Fuel circuit:
  - 1 rotomolded 300L / 79 US gal tank (+300L with the essential equipment in the port cabin under the floor)
  - Fuel filter systems
  - Fuel shut off valve
  - Gauge at the general control panel on touch screen
- Access to the engine compartments from the transom through hatches

## Plumbing

### FRESH WATER CIRCUIT

- 300L / 79 US gal fresh water tank
  - Gauge at the general control panel on touch screen
- Fresh water circuit with 1 main water group in the aft port engine compartment
- 40L / 11 US gal electric water heater, 230V/engine exchanger

### GREY WATER

- Shower and sink drain to grey water tank and automatic pump

### BLACK WATER

- 3 cabin 3 head version: 3 tanks 80L / 21 US gal (total 240L / 63 US gal)
- 4 cabin 4 head version: 4 tanks 80L / 21 US gal (total 320L / 85 US gal)

### BILGE PUMPS CIRCUIT

- 1 manual bilge pump with cockpit pump per hull
- 1 automatic immersed bilge pump per hull
- 1 manual release non-immersed bilge pump per hull

## Electrical

### POWER CIRCUIT DC – 12V

- 2 alternators 12V - 125A
- 2 start batteries 12V - 110A
- 2 service batteries 12V - 140Ah (acid)

Battery circuit breaker in the engine compartments (just below the hatches)

### ELECTRIC DISTRIBUTION PANEL

- 12V General distribution panel at the chart table with protection by circuit breaker
- Ammeter, voltmeter, circuit breaker, panel lighting
- USB sockets 12V included in the electrical panel

**LIGHTING**

- Recessed 12V LED spotlights in ceiling
- 12V LED reading light next to bunks
- 12V LED chart table light
- 12V lighting in engine compartment
- LED navigation lights

**Deck layout****TRANSOM**

- Hot/cold deck shower on starboard
- S/s telescopic swim ladder with fixed handle on starboard
- Small storage on the sides of the transom

**AFT COCKPIT**

- Cockpit usable as a deck saloon, protected by a hard top bimini
- L-shaped bench with 1 storage locker and 10 kg / 22 lb gas bottle under the seat
- Removable polyester cockpit table 6/8 people (1400x820mm / 4'7"x2'8")
- Storage locker on portside (cockpit fridge 95L / 25 US gal or ice maker option)
- Lounger on port side with storage locker
- Polyester fiddle anti-runoff on the sides of the cockpit
- Access to the engine compartments through hatches with gas struts
- Aft crossbeam with stainless steel backrest

**HELM STATION**

- Composite staircases to access from the cockpit
- Double stainless steel helm seat
- Leather covered stainless steel steering wheel diam. 800mm / 31in
- Console for screen and instrumentation
- Engine throttle and panel
- Cup holder
- USB outlet (included in the Navigation Pack option)
- Sheets bag on the starboard side of the helm station
- Winch handle holder
- Access to coachroof via a staircase with teak steps and s/s structure + handrail (bimini option)

## FORWARD COCKPIT

- Large hatch on starboard with gas s/s struts and locker for the access to the fresh water tank
- Locker on portside with gas s/s struts (300L / 79 US gal) additional fresh water tank or generator option)
- Trampoline (nylon)

## BOW LOCKERS

- Access through opening deck hatches with locker (T60 - 507x507mm / 1'8"x1'8")
- Lighting
- Grey painting
- Inboard side porthole (347x171mm / 1'2"x 7in) (if berth option)

## STANCHIONS AND LIFE LINES

- Pushpits with flag support
- Stanchions: H 610mm / 24in
- Double lifelines

## Windows, opening and ventilation

- Sliding door
- Deck hatches:
  - Flush deck hatch T10
  - Flush deck hatch T44
  - Flush deck hatch T60
- Hull portholes
  - Fixed PMMA portholes with integrated openings

## Interior layouts

### GENERAL

- Interior woodwork in Alpi Walnut plywood
- Asburgo laminated floor
- Door to access to the cabins and bathroom without doorstep
- S/s handrail leather covered
- Stretched canvas covered ceiling in the saloon
- Fabric-covered forward saloon bulkhead
- Fabric-covered plywood ceiling in the owner cabin
- Polyester ceiling in the owner bathroom
- Polyester ceiling in the forward cabin
- Fabric-covered plywood ceiling in the aft cabin
- Polyester ceiling in the forward and aft bathroom
- Fabric-covered plywood on hull liner in cabins

## STANDING HEADROOM

Cockpit:	2.20m / 7'3"
Saloon:	2.00m / 6'7"
Forward cabin:	2.00 m / 6'7"
Aft cabin:	1.90 m / 6'3"
Bathroom:	1.90 m / 6'3"

#### MATTRESSES AND UPHOLSTERY

- Marine mattresses made of multi-layer alveolar foam with several densities (tick. 130mm / 5in)
- Mattresses treatment: anti-microbial, anti-bacterial, non-allergenic, anti-dust mite
- Standard upholstery as indicated on Lagoon sample book
- Synthetic fabrics adapted to marine environment:
  - washable (40°C / 104°F)
  - U.V. resistant
  - water repellent, with anti-stain treatment
- Blinds and curtains:
  - Pleated fabric curtains for saloon
  - Blind model pleated-shade, blackout fabric for cabins
  - Roller blind in waterproof fabric for shower and head



### 3 cabins 3 bathroom



#### SALOON

Living area with:

- Sliding windows in aluminum, 3 sections, with locker for the access to the cockpit (2250 x 1900mm / 7'5" x 6'3"), blocking in different positions
- Wooden saloon table (Essential equipment)
  - Exchangeable with the coffee table (option)
  - Convertible in berth (option)
- 6 seats L-shaped bench on front starboard
- 1 fixed bench 2 seats in front of the L-shaped seating area
- 3 lockers under the bench (1 for the option air conditioning/heating)
- Stainless steel mast support strut
- 2 opening portholes in the front window (482x342mm / 1'7"x1'1")

#### CHART TABLE

- Large instrument console with panel to install the electronics that can be built in (finishing with soft touch paint color *Titanium*)
- 1 desk with 1 flap and 3 pencil holders
- Electric panel in the starboard companionway (Generator, water maker, AC, DC, inverter controls)

#### GALLEY

On starboard:

- U-shaped galley
- Laminated Volcanic Ash with molded wood countertop
- S/s sink with hot/cold mixer tap
- 1 door with a 25L / 7 US gal waste bin under the sink
- 1 cutlery drawer under the countertop
- 1 gas oven under the countertop
- 3 burner gas stove
- Storage niches under the stove

- Low storage cupboards with shelves, access from the saloon
- Open storage next to the entrance
- High storage cupboards
- Microwave (optional)

On portside:

- Low cupboard with:
  - Open storage
  - Fridge 130L / 34 US gal
  - Additional fridge with top access 100L / 26 US gal (option - not compatible with ice box)
  - Ice box with top access 100L / 26 US gal (option - not compatible with additional fridge)
  - TV on bulkhead (option)
- High storage cupboards

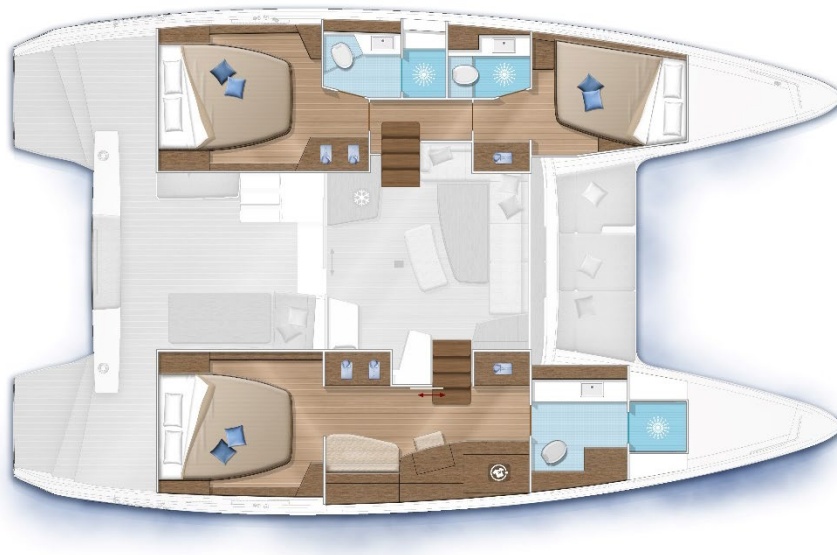

## PORT HULL

### Aft cabin

- Double bed with front and lateral access (2,05m x 1,80m / 6'9"x5'11")
- 2 bed nightstands
- 1 under bed drawer
- 1 wardrobe - inboard side
- 1 storage cupboard - inboard side
- 1 opening deck hatch with dorade box (T44 - 442x442mm / 1'5"x1'5")
- 1 opening hull porthole (T30 - 347x171mm / 1'2"x 7in)
- 1 fixed hull window in black PMMA (1200 x 420mm / 3'11"x1'5")
- 1 fixed hull window in black PMMA overlooking the back (230 x 1400mm / 9inx4'7")
- 1 opening hull porthole overlooking the back above the fixed window (347x171mm / 1'2"x 7") (essential equipment)

### Aft bathroom

- Composite countertop
- Sink with hot/cold mixer tap
- High storage: 1 shelf, 1 mirror, 2 niches
- Low storage: 1 door, 2 shelves
- Separate shower with Plexiglas door
- Manual toilet
- 1 opening deck hatch with dorade box (T10 - 260x260mm / 10in x 10in)

### Forward cabin

- Double bed with front and lateral access (2.00m x 1.20m x 1.30m at foot / 6'7"x3'11"x4'3")
- 1 under bed drawer
- 1 wardrobe – inboard side
- 1 storage niche with 1 shelf – inboard side
- 1 opening deck hatch with dorade box (T44 - 442x442mm / 1'5"x1'5")
- 1 opening hull porthole (T30 - 347x171mm / 1'2"x 7in)
- 1 fixed hull window in black PMMA (1200 x 420mm / 3'11"x1'5")

### Forward bathroom

- Composite countertop
- Sink with hot/cold mixer tap
- High storage: 1 mirror, 2 niches
- Low storage: 1 door, 2 shelves
- Integrated shower
- Manual toilet
- 1 opening deck hatch with dorade box (T10 - 260x260mm / 10in x 10in)

## STARBOARD HULL

### Owner cabin

- Access from the saloon through a sliding door

### Sleeping area:

- Double bed with front and lateral access (2,05m x 1,80m / 6'9"x5'11")
- 2 bed nightstands
- 1 under bed drawer
- 1 opening deck hatch with dorade box (T44 - 442x442mm / 1'5"x1'5")
- 1 opening hull porthole (T30 - 347x171mm / 1'2"x 7")
- 1 fixed hull window in black PMMA (1200 x 420mm / 3'11"x1'5")
- 1 fixed hull window in black PMMA overlooking the back (230 x 1400mm / 9in x 4'7")
- 1 opening hull porthole overlooking the back above the fixe window (347x171mm / 1'2"x 7") (essential equipment)

### Working area:

- 1 cupboard with shelve behind the door – inboard side
- 1 wardrobe in front of the door – inboard side
- 1 sofa 2 seats – outboard side
- 1 desk with flap – outboard side

- Bookshelves – outboard side
- 1 large storage with:
  - Wardrobe in the upper part (washing machine option)
  - Cupboard with shelves in the lower part
- 2 opening deck hatches with dorade box (T10 - 260x260mm / 10in x 10in)

#### **Owner bathroom**

- Composite countertop
- Sink with hot/cold mixer tap
- High storage: 1 shelf, 1 mirror, 4 niches above the sink
- High storage: 1 door with shelves above the sink
- Low storage: 3 doors with shelves outboard side
- Manual toilet
- Separate shower with Plexiglas door
- 1 opening deck hatch with dorade box (T44 - 442x442mm / 1'5"x1'5")
- 1 opening hull porthole (T30 - 347x171mm / 1'2"x 7")
- 1 fixed hull window in black PMMA (1200 x 420mm / 3'11"x1'5")

## 4 cabins 4 bathroom



### SALOON

Living room area with:

- Sliding windows in aluminum, 3 sections, with locker for the access to the cockpit (2250 x 1900mm / 7'5"x6'3"), blocking in different positions
- Wooden saloon table (Essential equipment)
  - Exchangeable with the coffee table (optional)
  - Convertible in berth (optional)
- 6 seat L-shaped bench on front starboard
- 1 fixed bench 2 seats in front of the L-shaped seating area
- 3 lockers under the bench (1 for the option air conditioning/heating)
- Stainless steel mast support strut
- 2 opening portholes in the front window (482x342mm / 1'7"x1'1")

### CHART TABLE

- Large instrument console with panel to install the electronics that can be built in (finishing with soft touch paint color *Titanium*)
- 1 desk with 1 flap and 3 pencil holder
- Electric panel in the starboard companionway (Generator, water maker, AC, DC, inverter controls)

### GALLEY

On starboard:

- U-shaped galley
- Laminated Volcanic Ash with molded wood countertop
- S/s sink with hot/cold mixer tap
- 1 door with a 25L / 7 US gal waste bin under the sink
- 1 cutlery drawer under the countertop
- 1 gas oven under the countertop
- 3 burner gas stove
- Storage niches under the stove
- Low storage cupboards with shelves, access from the saloon

- Open storage next to the entrance
- High storage cupboards
- Microwave (optional)

On port side:

- Low cupboard with:
  - Open storage
  - Fridge 130L / 34 US gal
  - Additional fridge with top access 100L / 26 US gal (option - not compatible with ice box)
  - Ice box with top access 100L / 26 US gal (option - not compatible with additional fridge)
  - TV on bulkhead (option)
- High storage cupboards



## PORT HULL

### Aft cabin

- Double bed with front and lateral access (2.05m x 1.80m / 6'9"x5'11")
- 2 bed nightstands
- 1 under bed drawer
- 1 wardrobe - inboard side
- 1 storage cupboard - inboard side
- 1 opening deck hatch with dorade box (T44 - 442x442mm / 1'5"x1'5")
- 1 opening hull porthole (T30 - 347x171mm / 1'2"x 7in)
- 1 fixed hull window in black PMMA (1200 x 420mm / 3'11"x1'5")
- 1 fixed hull window in black PMMA overlooking the back (230 x 1400mm / 9inx4'7")
- 1 opening hull porthole overlooking the back above the fixe window (347x171mm / 1'2"x 7") (essential equipment)

### Aft bathroom

- Composite countertop
- Sink with hot/cold mixer tap

- High storage: 1 shelf, 1 mirror, 2 niches
- Low storage: 1 door, 2 shelves
- Separate shower with Plexiglas door
- Manual toilet
- 1 opening deck hatch with dorade box (T10 - 260x260mm / 10in x 10in)

#### Forward cabin

- Double bed with front and lateral access (2.00m x 1.20m x 1.30m at foot / 6'7"x3'11"x4'3")
- 1 under bed drawer
- 1 wardrobe – inboard side
- 1 storage niche with 1 shelf – inboard side
- 1 opening deck hatch with dorade box (T44 - 442x442mm / 1'5"x1'5")
- 1 opening hull porthole (T30 - 347x171mm / 1'2"x 7")
- 1 fixed hull window in black PMMA (1200 x 420mm / 3'11"x1'5")

#### Forward bathroom

- Composite countertop
- Sink with hot/cold mixer tap
- High storage: 1 mirror, 2 niches
- Low storage: 1 door, 2 shelves
- Integrated shower
- Manual toilet
- 1 opening deck hatch with dorade box (T10 - 260x260mm / 10" x 10")

### STRABOARD HULL

#### Aft cabin

- Double bed with front and lateral access (2.05m x 1.80m / 6'9"x5'11")
- 2 bed nightstands
- 1 under bed drawer
- 1 wardrobe – inboard side
- 1 opening deck hatch with dorade box (T44 - 442x442mm / 1'5"x1'5")
- 1 opening hull porthole (T30 - 347x171mm / 1'2"x 7")
- 1 fixed hull window in black PMMA (1200 x 420mm / 3'11"x1'5")
- 1 fixed hull window in black PMMA overlooking the back (230 x 1400mm / 9inx4'7")
- 1 opening hull porthole overlooking the back above the fixe window (347x171mm / 1'2"x 7") (essential equipment)

#### Aft bathroom

- Composite countertop
- Sink with hot/cold mixer tap
- High storage: 1 shelf, 1 mirror, 2 niches
- Low storage: 1 door, 2 shelves
- Separate shower with Plexiglas door
- Manual toilet
- 1 opening deck hatch with dorade box (T10 - 260x260mm / 10" x 10")

**Forward cabin**

- Double bed with front and lateral access (2.00m x 1.20m x 1.30m at foot / 6'7"x3'11"x4'3")
- 1 under bed drawer
- 1 wardrobe – inboard side
- 1 storage niche with 1 shelf – inboard side
- 1 opening deck hatch with dorade box (T44 - 442x442mm / 1'5"x1'5")
- 1 opening hull porthole (T30 - 347x171mm / 1'2"x 7in)
- 1 fixed hull window in black PMMA (1200 x 420mm / 3'11"x1'5")

**Forward bathroom**

- Composite countertop
- Sink with hot/cold mixer tap
- High storage: 1 mirror, 2 niches
- Low storage: 1 door, 2 shelves
- Integrated shower
- Manual toilet
- 1 opening deck hatch with dorade box (T10 - 260x260mm / 10" x 10")





LAGOON

162, quai de Brazza  
CS 81217  
33072 Bordeaux Cedex - France  
Tél. 33 + (0) 557 80 92 80  
E-mail : [info@cata-lagoon.com](mailto:info@cata-lagoon.com)  
[www.cata-lagoon.com](http://www.cata-lagoon.com)